

# A handbook for patients, their family or carers travelling to the

Royal Hobart Hospital

# Royal Hobart Hospital



The Department of Health and Human Services (the Department) is pleased to provide this information booklet. This booklet has been designed to provide you with much of the information you will need to get around the hospital and the local area. It includes information about transport, carpark, banking, chemist, accommodation and other support services.

The accommodation list is provided for information only. All the listed accommodation providers have agreed to publish the information in this booklet. The Department is not affiliated with any business and has no responsibility to inspect or control operations on the premises. The Patient Travel Assistance Scheme Coordinators would appreciate knowing if the accommodations do not meet patient expectations.

All rates are subject to change without notice. Visitors should contact the individual accommodation providers for further details (e.g. check in/out times, cancellation policies, etc.). Any concerns with the facilities should be discussed and resolved with the accommodation provider.

Updated December 2008

# Royal Hobart Hospital

The Royal Hobart Hospital (RHH) is Tasmania's largest hospital and the major referral centre. As the major centre of clinical teaching and research, it has a strong collaborative relationship with the University of Tasmania and other institutions.

The RHH provides acute, sub acute, mental health and aged care inpatient and ambulatory services to Hobart and surrounding areas. A comprehensive range of general and specialty medical and surgical services are provided including many statewide services such as cardiac surgery, neurosurgery, extensive burns treatment, hyperbaric medicine, neonatal & paediatric intensive care and high risk obstetrics.

Critical care services are often the patients' first point of contact and are divided into intensive care services and emergency medicine services. Other RHH facilities include the Geriatric Evaluation and Monitoring Unit and the Transitional Care Unit at the old Repatriation Hospital complex in Davey Street, and the Renal Unit at St John's Park, Newtown.

## Contact Details

48 Liverpool Street, Hobart, Tasmania, 7000

Phone: (03) 6222 8308

Fax: (03) 6231 3520

Enquiries counter for this Hospital is located at main entrance off Liverpool Street.

## Opening Hours

The RHH is a 24 hour facility; however various departments within the hospital have their own operating hours. Recommended general visiting time is between 12noon – 1:30pm and 3-8pm.

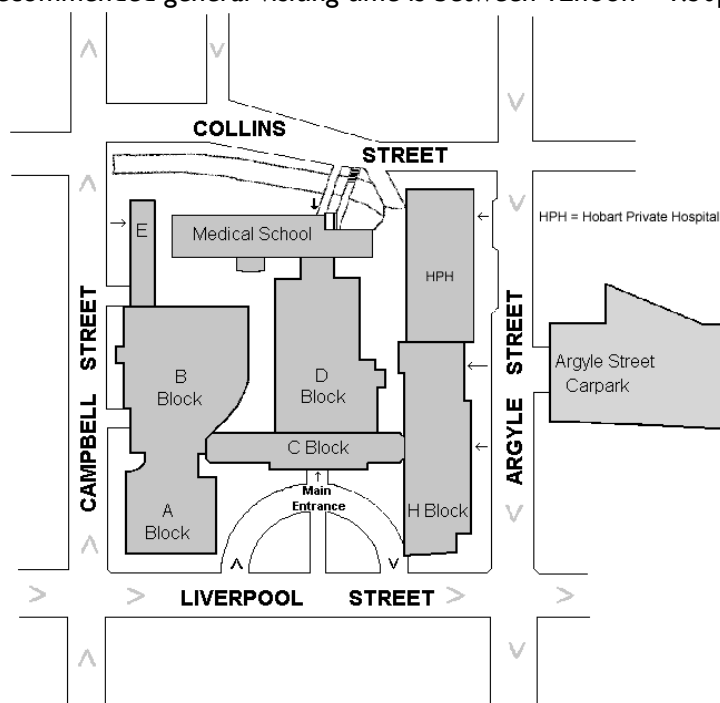

## Site Plan

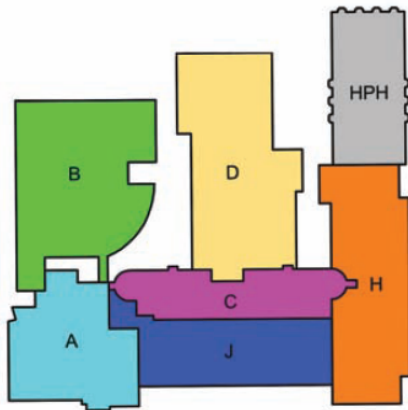

### A BLOCK

- G WP Holman Clinic
- 1 Dwyer Rehabilitation Unit
- 2 Orthopaedic Unit
- 3 Paediatric Unit
- 4 Day Surgery Unit
- 5 Burns Unit, Surgical Specialties Unit, Oral and Maxillofacial Unit
- 6 General Surgical and Women's Health Service
- 7 Podiatry, Dieticians, Speech Pathology, Diabetes
- 8 Aboriginal Health, Occupational Therapy, Patient Transport, Social Work
- 9 Executive Offices, Community Relations Unit

### B BLOCK

- G Department of Psychological Medicine
- 1 Ward 1B North, Ward 1B South, 1B South Oncology Outpatients
- 2 Ward 2B North, Ward 2B South, Stroke Unit

### C BLOCK

- G Accounts Receivable, Baby Feeding Room, Kiosk/Coffee Shop, Reception, Television Hire, Automatic Teller Machine (ATM)
- 1 Chapel, Community & Consumer Advisory Service
- 2 Specialist's Clinics
- 3 Paediatric Clinics, Women's and Children's Clinics
- 4 Elective Surgery Booking Office, Pre-admissions Clinic

### D BLOCK

- B Grief Counsellor
- G Dining Room
- 2 Ward 2DC, Ward 2DS, Pain Management Unit
- 3 Maternity Unit, Paediatric and Neonatal Intensive Care Unit, Outpatient Clinics
- 4 Main Operating Theatres
- 5 Pharmacy Department

### H BLOCK

- LG Centrepath
- G Medical Imaging
- 1 Department of Critical Care Medicine
- 1 Neurosurgery Unit
- 2 Orthopaedic/Fracture Clinic
- 3 Eye Clinic

### J BLOCK

- LG Emergency Department

## **Social Work Department**

Social Workers work with individuals, families and community groups and they can assist you and your family in a variety of ways:

- **Psycho-social assessment:** evaluation and review of presenting problems and circumstances
- **Counselling:** alleviation of psycho-social problems, including personal and relationship difficulties
- **Crisis intervention:** assistance in coping in crisis situations
- **Bereavement intervention:** assistance in coping in situations of terminal illness, unexpected acquired disability or bereavement
- **Education and information:** provision of information regarding health issues, human development, interpersonal and social skills and coping strategies
- **Discharge planning:** collaboration with other health professionals to facilitate care coordination and continuity of care
- **Service coordination:** arrangement, facilitation and coordination of a range of services necessary to meet identified client needs
- **Liaison:** exchange of information with other service providers for the purpose of facilitating client service delivery
- **Referral:** assistance to access an agency, resource or professional known to be able to provide a needed service(s)
- **Advocacy:** direct representation or defence of the client's interest to ensure that the client's rights or entitlements are maintained

Social Workers can be contacted on

Location: 8 Floor, A Block, Royal Hobart Hospital  
Phone: (03) 6222 8354  
Fax: (03) 6222 8949

## Patient Travel Assistance Scheme (PTAS)

The Patient Travel Assistance Scheme provides financial assistance with travel and/or accommodation costs to Tasmanian permanent residents to access a range of specialist medical services where the services are not available locally.

This is an assistance scheme and you are expected to make a patient contribution.

### Am I eligible for PTAS?

You will be eligible for financial assistance under the PTAS if you:

- are a Tasmanian permanent resident;
- are being referred to
  - the nearest dialysis/oncology treatment centre more than 50 km (one-way) from your home; or
  - a specialist medical service/lymphedema treatment more than 75 km (one-way) from your home **or** not available in Tasmania;
- are travelling by a normal form of transport (the scheme does not meet ambulance costs);
- have a PTAS application form signed by your referring medical specialist, oral/maxillofacial surgeon or rural GP referring you to the nearest appropriate specialist; and
- receive treatment claimable under Medicare from a recognised medical specialist; and
- are not entitled to financial assistance through another scheme e.g. Motor Accident Insurance Board (MAIB), Department of Veterans Affairs (DVA), Workers Compensation, or other compensable schemes.

### What financial assistance is available for travelling in Tasmania?

Financial assistance is available towards approved air/sea and road travel, and accommodation (where applicable) expenses. You can either make your own travel and/or accommodation arrangements, and to claim reimbursement on your return home from the specialist treatment, or organise with your local PTAS Coordinator to pre-book your travel and/or accommodation.

The reimbursement rate for you and your approved escort(s) are as follows:

#### Travel

- the cost of return economy bus tickets, or
- private vehicle travel (19 cents/km) to and from the medical facility.

#### Residents of King Island and the Furneaux Islands

- the cost of a return economy airfare (island resident rates), plus the cost of the most economical, appropriate form of transport from the destination airport to and from the medical facility.

#### Accommodation

- a maximum of \$46 per night for commercial accommodation for each approved person.

## **Can I have someone to travel with me?**

The Scheme also assists with the travel and accommodation costs of an escort accompanying you if you are under the age of 18 years.

If you are aged 18 years or over, an escort may be eligible for financial assistance if the escort is necessary to actively assist you during your travel or treatment.

In some exceptional circumstances, approval may be given for financial assistance for more than one escort.

## **What contribution do I make?**

### **Travel**

Health Care Card or Pensioner Concession Card Holders are required to contribute \$15 towards the cost of each return journey. Non-card holders are required to contribute \$75 towards the cost of each return journey.

In any one financial year, the maximum contribution for a card-holder is \$120, and for a non-cardholder is \$300. If these limits are reached no further contributions will be required for that year. You and any approved escort are required to meet the additional costs incurred if they choose a more expensive form of transport than that approved (e.g. travel by air when road transport is assessed as appropriate).

### **Accommodation**

You and your approved escort are required to meet the cost where the accommodation cost is over the \$46 per night per approved person.

Non-card holders and your escort are required to pay the first two nights' accommodation costs for each stay.

## **How do I apply for assistance?**

Your referring medical specialist or rural general practitioner will normally provide you with the PTAS application form when you are referred for a specialist medical service. They should complete Section A of the PTAS application form at this time and give it to you to deliver to your local PTAS Coordinator.

It is important to note that the lodgement of an application form does not in itself represent approval.

### **Patient Travel Assistance Scheme Office**

Location: 8th Floor, A Block, Royal Hobart Hospital  
Phone: (03) 6222 8225  
Fax: (03) 6222 8949  
Switchboard Phone: (03) 6222 8308

# Transport

## Public Transport

---

Bus stop at the corner of Liverpool Street and Campbell Street near the main entrance of the Royal Hobart Hospital.

The main bus depot is located on Elizabeth Street, between Collins and Macquarie Street.

## Airlines

---

Tiger Airways	(03) 9335 3033	<a href="http://www.tigerairways.com">http://www.tigerairways.com</a>
Virgin Blue	13 67 89	<a href="http://www.virginblue.com.au">http://www.virginblue.com.au</a>
Qantas	13 13 13	<a href="http://www.qantas.com.au">http://www.qantas.com.au</a>
Jetstar	131 538	<a href="http://www.jetstar.com">http://www.jetstar.com</a>

*Note: if require wheelchair, or assistance, please organise on booking flights. Most airlines will provide support to and from flights.*

## Airport Bus Service

---

Airporter Bus Service 0419 382 240

Operates between the Hobart CBD (accommodation hotels, motels etc) and the airport for every departure. The shuttle departs outside the terminal after the arrival of every flight transferring passengers to the city.

## Taxi

---

Taxi Combined Services (Hobart) Pty Ltd	13 22 27
City Cabs	13 10 08
United Taxis	(03) 6278 2244
Yellow Cab Co	13 19 24

## Hire car operators

---

Avis	13 63 33
Hertz	(03) 6234 1955
Thrifty	(03) 6333 0911
Budget	13 27 27
Europcar	13 13 90



## Carpark

---

### Short-term Patient Pick-up and Drop-off

Short term ten (10) minute parking for people with disabilities, and/or for patient drop off/pick up is available at the Liverpool, Argyle and Campbell Street entrances. Please note, the Argyle and Campbell Street entrances are closed between the hours of 8.30pm to 6am.

Hobart City Council (HCC) parking officers patrol RHH parking spaces and parking tickets will be issued for unauthorised parking. The RHH accepts no responsibility for payment of fines nor is the RHH able to waive fines.

Argyle Street Carpark (HCC)	Entry is from Argyle Street, Hobart <i>Mon -Fri 8.30am - 6.30pm, Sat 8.30am - 5.30pm, Sun 9.30am - 4.30pm</i>
Centrepoint Carpark (HCC)	Entry is from Victoria Street (off Harrington Street), Hobart <i>Mon -Fri 8.30am - 6.30pm, Sat 8.30am - 5.30pm, Sun 9.30am - 4.30pm</i>
Hobart Central Carpark (HCC)	Entry is from Melville Street, Hobart <i>Mon-Fri 8.30am - 6.30pm, Sat 8.30am - 5.30pm</i>
Market Place Car Park (non council car park)	Entry is from Market Place, Hobart <i>24 hours a day, seven (7) days per week</i>
Trafalgar Car Park (non council car park)	Entry is from Macquarie Street (opp Franklin Square), Hobart <i>Mon-Thu 7.00am - 7.00pm, Fri 7.00am - 9.00pm, Sat 8.00am - 5.30pm</i>

### Street Parking

Managed by the Hobart City Council, metered parking spaces are available in Campbell, Liverpool, Argyle and Collins Streets.

### Cancer Patient Transport System (*transport 2 treatment*)

---

The Cancer Council Tasmania provides transport for Tasmanian cancer patients and their carers travelling to treatment through a program called *transport 2 treatment*. The *transport 2 treatment* program provides a range of transport options as well as travel assistance for cancer patients around Tasmania. The program can also reimburse travel costs to people transporting friends or relatives to treatment and offers financial assistance to patients who can drive themselves but have difficulty meeting the high costs of travel.

Phone: (03) 6233 2030

Web: <http://www.cancertas.org.au/pages/transport.phpport.php>

Email: [infotas@cancertas.org.au](mailto:infotas@cancertas.org.au)

## Other services

### Centrelink Customer Service Centre

---

Commonwealth Centre, 188 Collins Street, Hobart  
Mon - Fri 8.00am – 5.00pm

1800 050 004

<http://www.centrelink.gov.au>

### Medicare

---

Shop 7 Trafalgar Centre 110 Collins Street, Hobart  
Mon - Fri 8.30am - 5.00pm; (excluding Public Holidays)

13 20 1

<http://www.medicareaustralia.gov.au>

### Banking

---

A MyState Financial ATM is located on the Ground floor of the Liverpool Street entrance foyer, beside the Central Auxiliary Kiosk & Coffee Shop.

ANZ	40 Elizabeth Street, Hobart
Bendigo Bank	45 Murray Street, Hobart
Commonwealth Bank	81 Elizabeth Street, Hobart
MyState Financial	144 Collins Street, Hobart
National Australia Bank	76 Liverpool Street, Hobart
Westpac Bank	28 Elizabeth Street, Hobart

### Chemist

---

Centrepont Amcal Chemist	201/70 Murray Street, Hobart
Chemist On Collins	93 Collins Street, Hobart
Chemist Warehouse Hobart	144-160 Murray Street, Hobart
Hobart Friendly Care Pharmacies	103 Liverpool Street, Hobart
Macquarie Pharmacy	80 Macquarie Street, Hobart
Morgans Pharmacy	164 Macquarie Street, Hobart
Priceline	Shop F10 Elizabeth Plaza, Elizabeth Mall, Hobart

### Supermarket

---

Liverpool Supermarket	148 Liverpool Street, Hobart
Woolworths	189 Campbell Street, Hobart

### Food

---

Visitors may purchase meals at a reasonable price in the hospital dining room between 9 am and 7.30 pm. The dining room is located on the ground floor D Block.

Some café and restaurants are located close to the hospital. A list of café and restaurants can be found from Yellow Pages.

# Map of Hobart

Please note: the numbers in blue indicate the accommodation location on the maps.



## Accommodation

**BOOKING:** Please state that you are attending or with some one attending the Royal Hobart Hospital when booking accommodation.

P.O.A. = Price on application

- 
- |          |  |  |
|----------|--|--|
| <b>1</b> | <b>Abbey Apartments</b><br>101 Campbell Street<br>HOBART TAS 7000<br>Phone: (03) 6234 3197   | <u>Cost per night</u><br>\$90 - 110 per unit |
|          | <p>A fully equipped kitchen, electric heating, TV, video, toaster, kettle, clock radio, steam iron and ironing board. Share laundry facilities and vacuum cleaner, off street parking, 5 minutes walk to the hospital.</p> |  |
- 
- |          |   |   |
|----------|---|---|
| <b>2</b> | <b>Adelphi Court YHA</b><br>17 Stoke Street<br>NEW TOWN TAS 7008<br>Phone: (03) 6234 9617<br>Fax: (03) 6278 2047<br>Web: <a href="http://www.yha.tas.org.au">http://www.yha.tas.org.au</a><br>Email: <a href="mailto:adelphi@yhatastas.org.au">adelphi@yhatastas.org.au</a>   | <u>Cost per night</u><br>4 share dormitory:<br>\$25<br><br>Single/double with shared bathroom:<br>\$60 per room |
|          | <p>Property is 1.75 kms directly up Argyle Street from the RHH (turn right into Stoke Street). Off street parking is available and it is 150 metres to the Metro bus service to the city. A self catering kitchen is available for use by all guests with all cutlery crockery etc provided. Large common room with TV and internet access.</p> | Single/double with ensuite:<br>\$72 per room<br><br>\$22 extra person   |
- 
- |          |   |  |
|----------|---|--|
| <b>3</b> | <b>Apartments on Strickland</b><br>197 Strickland Avenue<br>SOUTH HOBART TAS 7004<br>Phone: (03) 6243 6316<br>Web: <a href="http://www.apartmentsonstrickland.com.au">http://www.apartmentsonstrickland.com.au</a><br>Email: <a href="mailto:bookings@apartmentsonstrickland.com.au">bookings@apartmentsonstrickland.com.au</a> | <u>Cost per night</u><br>P.O.A.<br><br><u>Cost per week</u><br>\$680 - 875 for 2 people. Pending time of year, and for period of time and how many people. |
|          | <p>Fully self contained apartments, guest laundry, off-street parking, safe children's play area, on Metro bus route, 48 hours cancellation policy.</p>   |  |
- 
- |          |  |        |
|----------|--|--------|
| <b>4</b> | <b>Astor Private Hotel</b><br>157 Macquarie Street<br>HOBART TAS 7000<br>Phone: (03) 6234 6611<br>Fax: (03) 6234 6384<br>Web: <a href="http://www.astorprivatehotel.com.au">http://www.astorprivatehotel.com.au</a><br>Email: <a href="mailto:bookings@astorprivatehotel.com.au">bookings@astorprivatehotel.com.au</a> | P.O.A. |
|          | <p>Single, twin, double, share facilities, rooms with ensembles</p>  |        |
-

- 
- 5 Argyle Motor Lodge** Cost per night  
Cnr Argyle & Lewis Streets \$85 single  
NORTH HOBART TAS 7000 \$95 double  
Phone: (03) 6234 2488  
Fax: (03) 6234 2292 \$15 extra adult  
Email: [aml@argylemotorlodge.com.au](mailto:aml@argylemotorlodge.com.au) \$10 extra child

Motel room or self-contained studio, off street parking, tea/coffee making facilities, toaster. Self-contained studios have a full kitchen. Weekly stays can be upgraded to include kitchen if available. 15-20 minutes walk to the RHH, on Metro bus route.

- 
- 6 Brunswick Hotel** Cost per night  
67 Liverpool Street Share Facilities:  
HOBART TAS 7000 \$55 standard room  
Phone: (03) 6234 4981  
Fax: (03) 6234 4981 Ensuites:  
Web: <http://www.OLDHOBARTHOTEL.COM.AU> \$75 standard room  
Email: [jtfhotel@hotmail.com](mailto:jtfhotel@hotmail.com)

Stairs, hand basin in each room, share facilities, some parking, on Metro bus route, short walking distance to the RHH Cost per week  
\$180 standard room

- 
- 7 Central Café Bar** Cost per night  
73 Collins Street \$120 single/double  
HOBART TAS 7000  
Phone: (03) 6234 4419 \$40 extra person  
Fax: (03) 6231 4243  
Web: <http://www.CENTRALCAFEBAR.COM>  
Email: [central2@bigpond.net.au](mailto:central2@bigpond.net.au)

Modern style ensuite accommodation, tea and coffee making facilities, restaurant and gaming on site, stair only and no car parking. A fully cooked breakfast is included in the room tariff. 24 hour cancellation notice – credit card details require to confirm bookings.

- 
- 8 Customs House** Cost per night  
1 Murray Street \$110 single  
HOBART TAS 7000 \$125 double  
Phone: (03) 6234 6645  
Fax: (03) 6223 8750 \$40 extra person  
Web: <http://www.CUSTOMSHOUSEHOTEL.COM>  
Email: [karen@customshousehotel.com](mailto:karen@customshousehotel.com)

3.5 star accommodation, all rooms have ensuite, internet access, breakfast included, waterfront views (most rooms). 48 hours cancellation policy applies.

- 
- 9 David Collins Unit** Cost per night  
\$46 per room  
14/169 Risdon Road ((Enter from Lallaby Road))  
NEW TOWN TAS 7008  
Phone: 1300 728 533 – for bookings  
(03) 6278 1101 – Phone number at Unit

Priority given to Leukaemia patients, 2 bedroom unit, linen required.

- 
- 10 Fight Cancer Foundation House** Cost per night  
\$56 per room  
97-99 Murray Street  
HOBART TAS 7000  
Phone: (03) 6234 4030  
Web: <http://www.fightcancer.org.au>  
Email: [nicole.kanizay@fightcancer.org.au](mailto:nicole.kanizay@fightcancer.org.au)

Shared bathroom and cooking facilities, communal lounge, children's playroom, stairs, disable facilities, laundry facilities, short walking distance to the RHH

- 
- 11 Fountainside Motor Inn** Cost per night  
\$99  
single/twin/double  
\$165 suite apartment  
40 Brooker Avenue (Cnr Brooker Avenue and Liverpool Street)  
HOBART TAS 7000  
Phone: (03) 6234 2911  
Fax: (03) 6231 0710  
Web: <http://www.fountainside.com.au/>  
Email: [info@fountainside.com.au](mailto:info@fountainside.com.au)

Single, twin or double. Tea/coffee facilities, off-street parking, lift, guest laundry, restaurant and coffee shop, on Metro bus route, short walking distance to the RHH

- 
- 12 Graham Court Apartments** Cost per night  
\$95 single/double  
\$22 extra adult/child  
Cost per week  
\$560 single/double  
15 Pirie Street  
NEW TOWN TAS 7008  
Phone: (03) 6278 1333, 1800 811 915 (freecall)  
Fax: (03) 6278 1087  
Web: <http://www.grahamcourt.com.au>  
Email: [grahamcourt@vision.net.au](mailto:grahamcourt@vision.net.au)

1, 2 or 3 bedroom apartments available and 2 access apartment for people with disabilities. Self contained, 2 mins walk to Metro bus stop \$22 extra adult/child (per night)

- 
- 13 Hotel Grand Chancellor** Cost per night  
1 Davey Street \$140 Mountain View Room  
HOBART TAS 7000  
Phone: (03) 6235 4535  
Fax: (03) 6223 8175 \$175 Harbour View Room  
Web: <http://www.ghihotels.com.au>  
Email: [reservations@hgchobart.com.au](mailto:reservations@hgchobart.com.au)

Tea/coffee facilities, off-street parking, wheelchair access, guest laundry, lift, TV, restaurant, health club with gym and indoor heated swimming pool, 5 minutes walk to the RHH

Booking to be made via Patient Travel Assistance Scheme Coordinators at relevant hospital. Credit card imprint or \$50 deposit to secure incidentals

---

- 14 Grosvenor Court Apartments** P.O.A.  
42 Grosvenor Street  
SANDY BAY TAS 7005  
Phone: (03) 6223 3422  
Fax: (03) 6223 6344  
Web: <http://www.grosvenorcourt.com.au>  
Email: [grosvenorcourt@bigpond.com](mailto:grosvenorcourt@bigpond.com)

Fully self contained apartments, off-street parking, guest laundry, on Metro bus route, approx. 30 minutes walk to the RHH

All cancellations attract a charge of the first nights accommodation.

---

- 15 Hobart Mid City Hotel** Cost per night  
96 Bathurst Street (corner of Bathurst and Elizabeth Streets) \$109 single  
HOBART TAS 7000  
Phone: (03) 6234 6333 \$115 double  
Fax: (03) 6231 0898  
Web: <http://www.hobarthotel.com.au/index.jsp> \$30 extra adult  
Email: [bookings@hobartmidcity.com.au](mailto:bookings@hobartmidcity.com.au) \$15 extra child

Quality 3.5 – 4 star accommodation in the city centre. Single, twin or double. Free parking, WIFI, phone, TV, on site restaurant, bars, gaming lounge, on Metro bus route, 5 minutes walks to the RHH

---

- 16 Hobart Tower Motel** P.O.A.  
300 Park Street  
NEW TOWN TAS 7008  
Phone: (03) 6228 0166  
Fax: (03) 6278 1056  
Web: <http://www.hobarttower.com.au>  
Email: [hobtower@internode.on.net](mailto:hobtower@internode.on.net)

Off street parking, guest laundry, on Metro bus route, 25-30 minutes walks to the RHH

---

---

**17 Leisure Inn Hobart Macquarie** Cost per night  
\$99 per room  
167 Macquarie Street  
HOBART TAS 7000  
Phone: (03) 6220 1700 Cost per week  
\$672 per room  
Fax: (03) 6234 4273  
Web: <http://www.leisureinnhotels.com.au>  
Email: [hobartmacquarie@leisureinnhotels.com](mailto:hobartmacquarie@leisureinnhotels.com)

Off street parking, tea/coffee making facilities, guest laundry, restaurant, on Metro bus route, 5 minutes walk to the RHH.  
Check in is at 2 pm and check out is at 10 am. Not available peak periods, subject to availability.

---

**18 Leisure Inn Waterfront Lodge** Cost per night  
From \$69 per room  
153 Risdon Road  
NEW TOWN BAY TAS 7008  
Phone: (03) 6228 4748  
Fax: (03) 6228 1945  
Web: <http://www.leisureinnhotels.com>  
Email: [waterfrontlodge@leisureinnhotels.com](mailto:waterfrontlodge@leisureinnhotels.com)

Motel apartments, onsite parking, disabled facilities, kitchenettes including fridge and microwave, tea/coffee facilities, on Metro bus route to city

---

**19 Leisure Inn Woolmers Inn** Cost per night  
\$138 1 bedroom  
\$168 2 bedrooms  
123-127 Sandy Bay Road  
SANDY BAY TAS 7005  
Phone: (03) 6223 7355  
Web: <http://www.leisureinnhotels.com>  
Email: [woolmersinn@leisureinnhotels.com](mailto:woolmersinn@leisureinnhotels.com)

Self contained apartments, 1 & 2 bedroom apartments available, 1 disabled apartment, off-street parking, guest laundry, on Metro bus route to city

---

**20 Marquis Hotel/Motel** Cost per night  
\$100 single  
\$140 double  
\$40 extra adult  
\$20 extra child  
209 Brisbane Street  
WEST HOBART TAS 7000  
Phone: (03) 6234 3541  
Fax: (03) 6234 3141  
Web: <http://www.marquishotel.com.au/>  
Email: [reservations@marquishotel.com.au](mailto:reservations@marquishotel.com.au)  
  
Cost per week  
Depends on the time of year.

Ensuites in all rooms, tea/coffee making facilities, TV, laundry facilities. Breakfast available in the room, bistro available downstairs. All bookings are required to have a credit card.

---



<p><b>21 Montgomery's Private Hotel and YHA Backpackers</b>            9 Argyle Street            HOBART TAS 7000            Phone: (03) 6231 2660            Fax: (03) 6231 4817            Web: <a href="http://www.montgomerys.com.au/">http://www.montgomerys.com.au/</a>            Email: <a href="mailto:montys@yhata.org.au">montys@yhata.org.au</a></p> <p>Montgomerys Private Hotel is located approximately 150 metres from the Royal Hobart Hospital. Accommodation available ranges from private ensuite rooms (includes a room for people with disabilities), private rooms with shared bathroom and 6 and 8 bed dormitory style accommodation.</p> <p>Private ensuite rooms include queen size bed, TV, tea and coffee making facilities, refrigerator and heater. Standard rooms with shared facilities have a queen size bed. Family rooms are also available. Self catering kitchen for use of guests is located on the ground floor together with a laundry with coin operated equipment..</p>	<p><u>Cost per night</u>            Dorms:            \$27</p> <p>Single/Double shared facility:            \$100 per room</p> <p>Single/double ensuite:            \$117 per room</p>
<p><b>22 Mayfair Plaza Hotel</b>            236 Sandy Bay Road            SANDY BAY TAS 7005            Phone: (03) 6220 9900            Fax: (03) 6224 5255            Web: <a href="http://www.mayfairplaza.com.au">http://www.mayfairplaza.com.au</a>            Email: <a href="mailto:plazamotel@bigpond.com">plazamotel@bigpond.com</a></p> <p>Motel style accommodation. 1 wheelchair access room available, off-street parking, guest laundry, on Metro bus route, 30 minutes walk to the RHH</p>	<p><u>Cost per night</u>            From \$129 per room</p>
<p><b>23 Quest Savoy</b>            38 Elizabeth Street            HOBART TAS 7000            Phone: (03) 6220 2300            Fax: (03) 6224 0997            Web: <a href="http://www.questsavoy.com.au">http://www.questsavoy.com.au</a>            Email: <a href="mailto:questsavoy@questapartments.com.au">questsavoy@questapartments.com.au</a></p> <p>Off street parking, kitchen facilities, wheelchair access, guest laundry. One bedroom apartment and standand studio apartent are located in annexe building (different from Quest Savoy standard with stair access only). Cancel policy is 48 hours prior to arrival.</p>	<p>P.O.A. Racks can vary and be heavily discounted during the off-season.</p>

---

**24 Ronald McDonald House** Cost per night  
\$46 per room  
62 Collins Street  
HOBART TAS 7000  
Phone: (03) 6231 4877  
Web: <http://www.rmhc.org.au>  
Email: [rmhtasmania@bigpond.com](mailto:rmhtasmania@bigpond.com)

Shared bathroom and cooking facilities, lift, playroom, no parking.

---

**25 Scotts Flat** Cost per night  
\$45  
29 Bathurst Street  
HOBART TAS 7000  
Phone: (03) 6231 4498  
Fax: (03) 6234 2763  
Email: [scot-memorial@bigpond.com.au](mailto:scot-memorial@bigpond.com.au)

2 bedrooms unit, self contained, one parking space is provided, steep stairs,

---

**26 Shamrock Hotel** Cost per night  
\$60 single  
\$80 double  
195 Liverpool Street  
HOBART TAS 7000  
Phone: (03) 6234 3892  
Fax: (03) 6231 2921

Single, double or twin. Shared facilities, TV room, laundry, stairs, kitchenette. 1 x premium ensuite room.  
Tarrif includes continental breakfast.

Cost per week  
\$350 single  
\$500 double

---

**27 Sublime Pizzeria** Cost per night  
\$65 double  
145 Elizabeth Street  
HOBART TAS 7008  
Phone: (03) 6234 3501  
Fax: (03) 6231 1720

Double rooms or rooms with bunk beds that can sleep up to 6 people. All rooms have a private bathroom and are non-smoking. Access to rooms is via stairs. Short walking distance to the RHH.  
Payment upon arrival.

Cost per week  
\$350 double

---

<p><b>28 Theatre Royal Hotel</b>            31 Campbell Street            HOBART TAS 7000            Phone: (03) 6234 6925            Fax: (03) 6234 6356            Web: <a href="http://www.theatreroyalhotel.com">http://www.theatreroyalhotel.com</a>            Email: <a href="mailto:trhotel@bigpong.net.au">trhotel@bigpong.net.au</a></p> <p>Stairs, laundry, no parking, inroom continental breakfast included with room charge. Full payment for intended stay on check in.</p>	<p><u>Cost per night</u>            \$89 per room            shared facilities</p> <p>\$119 ensuite room</p>
<p><b>29 The Old Woolstore Apartment Hotel</b>            1 Macquarie Street            HOBART TAS 7000            Phone: (03) 6235 5355            Fax: (03) 6234 9954            Web: <a href="http://www.oldwoolstore.com.au/home">http://www.oldwoolstore.com.au/home</a>            Email: <a href="mailto:reservatuibs@oldwoolstore.com.au">reservatuibs@oldwoolstore.com.au</a></p> <p>Hotel room and apartment with 24 hours reception, room service plus security, free parking, guest lounge, onsite restaurant and bar. All apartments have both kitchen and laundry, approx. 5 minutes walking distance to the RHH.            Long term rates – minimum 14 consecutive night stay. Rates are subject to availability.            Patients must identify as a patient/carer at the time of booking.</p>	<p><u>Cost per night</u>            From \$119 per hotel room</p> <p>From \$119 per studio apartment (long term rates)</p> <p>\$40 extra person</p> <p>Children under 2 stay free with cot provided</p>
<p><b>30 Waratah Hotel</b>            272 Murray Street            HOBART TAS 7000            phone: (03) 6234 3685            Fax: (03) 6231 2365</p> <p>Rooms with ensuites, tea or coffee making facilities, restaurant, Keno, Bottleshop, gaming area, public bar, 15 minutes walk to the RHH.</p> <p>Fully cooked breakfast included in room rate.</p>	<p><u>Cost per night</u>            \$70 single            \$90 double</p> <p>\$40 extra adult            \$20 extra child</p>
<p><b>31 Welcome Stranger Hotel</b>            58 Harrington Street            HOBART TAS 7000            Phone: (03) 6223 6655            Fax: (03) 6224 1093            Web: <a href="http://www.welcomestrangerhotel.com.au">http://www.welcomestrangerhotel.com.au</a>            Email: <a href="mailto:welcomestranger@bigpond.com">welcomestranger@bigpond.com</a></p> <p>Ensuite and economy rooms. Off-street parking, guest laundry, restaurant, tea/coffee making facilities, on Metro bus route, 10 minutes walk to the RHH and 2 minutes walk to Whittle Ward</p>	<p><u>Cost per night</u>            \$70 per person            shared facilities</p> <p>\$95 ensuite room</p> <p><u>Cost per week</u>            \$550</p>



Tasmania  
Explore the possibilities